

NOTES :-

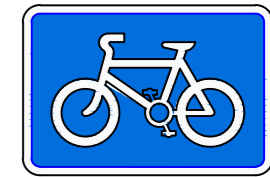

All TSRGD 967 plates to be mounted to existing lighting columns

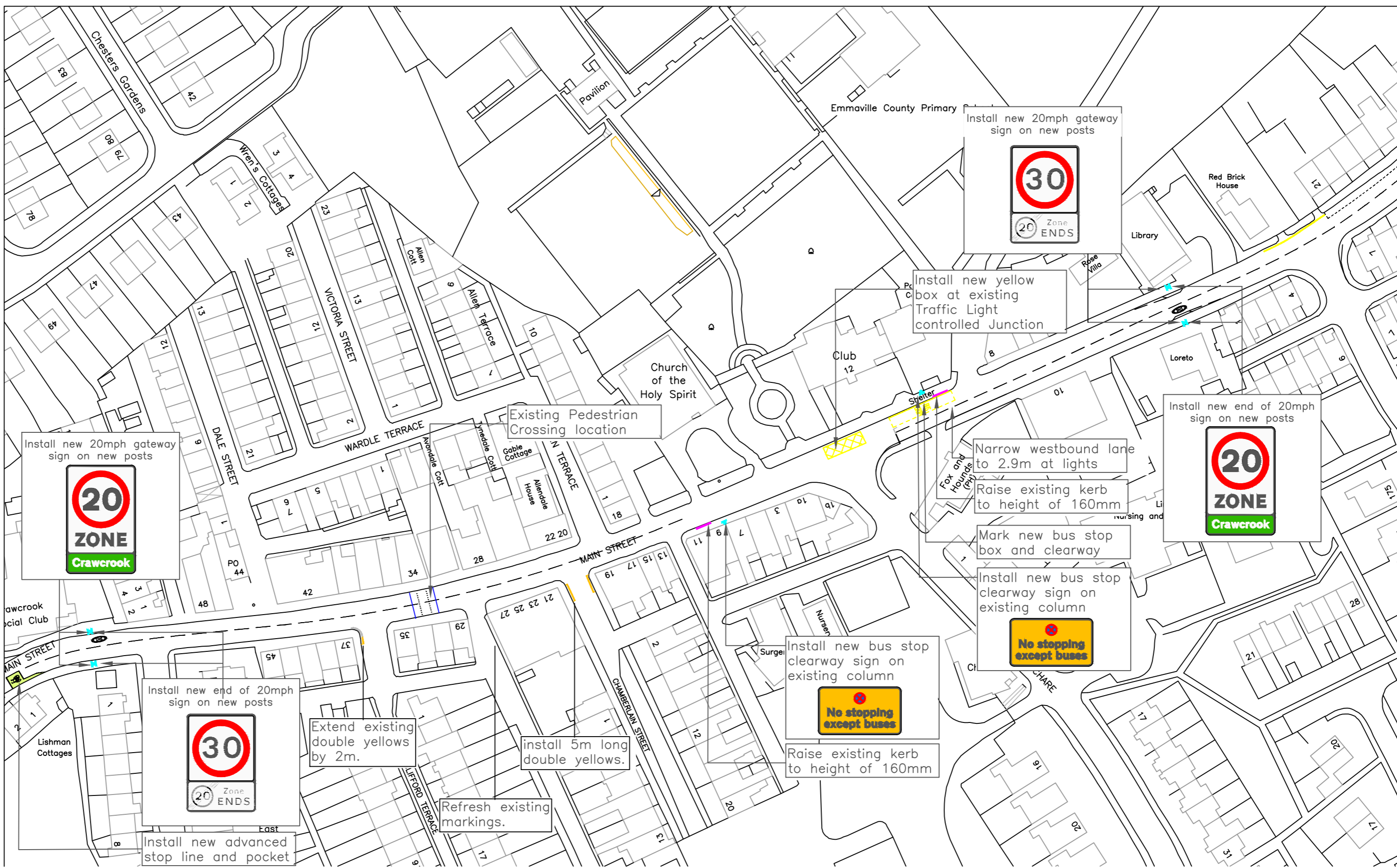
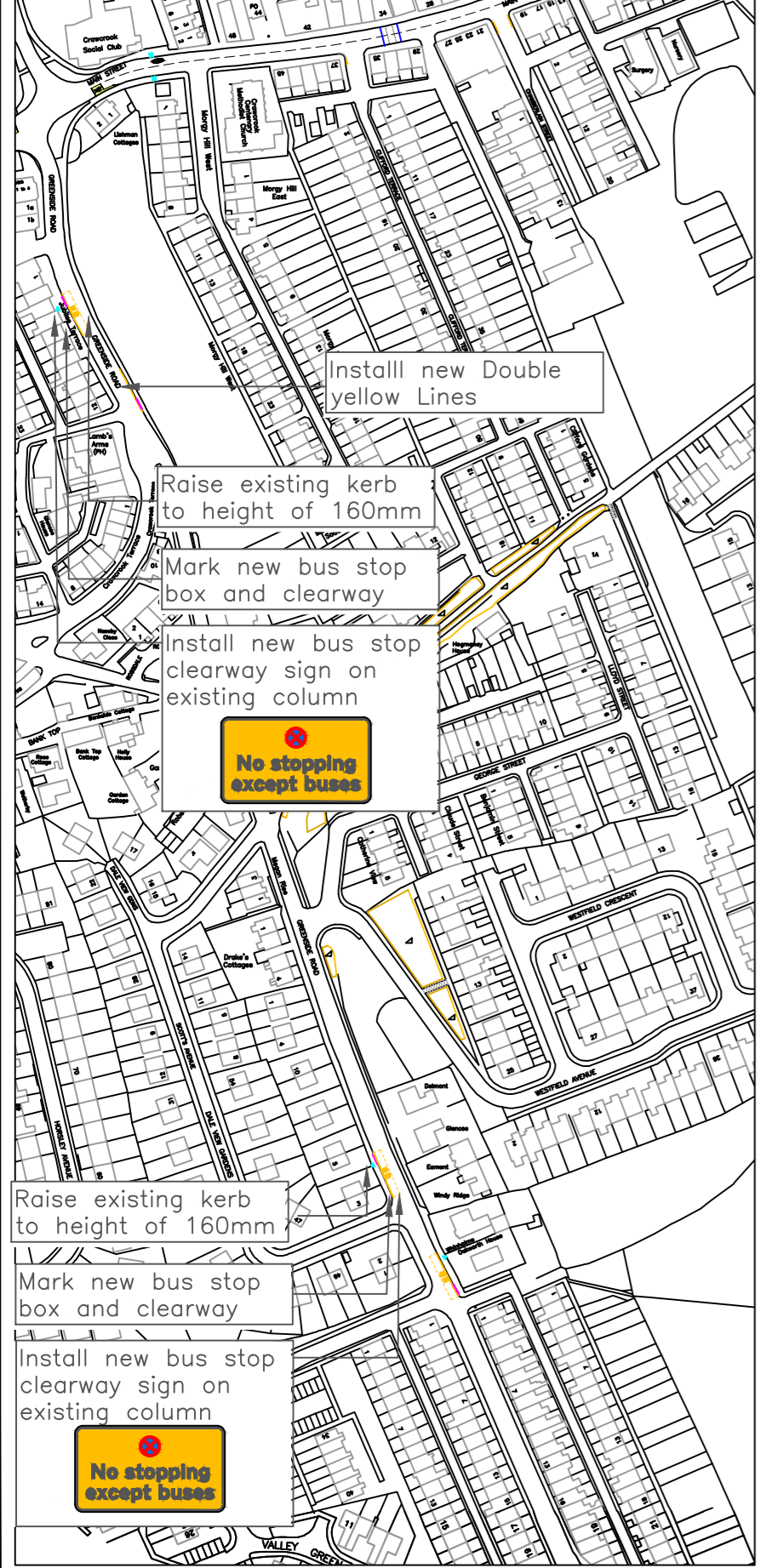
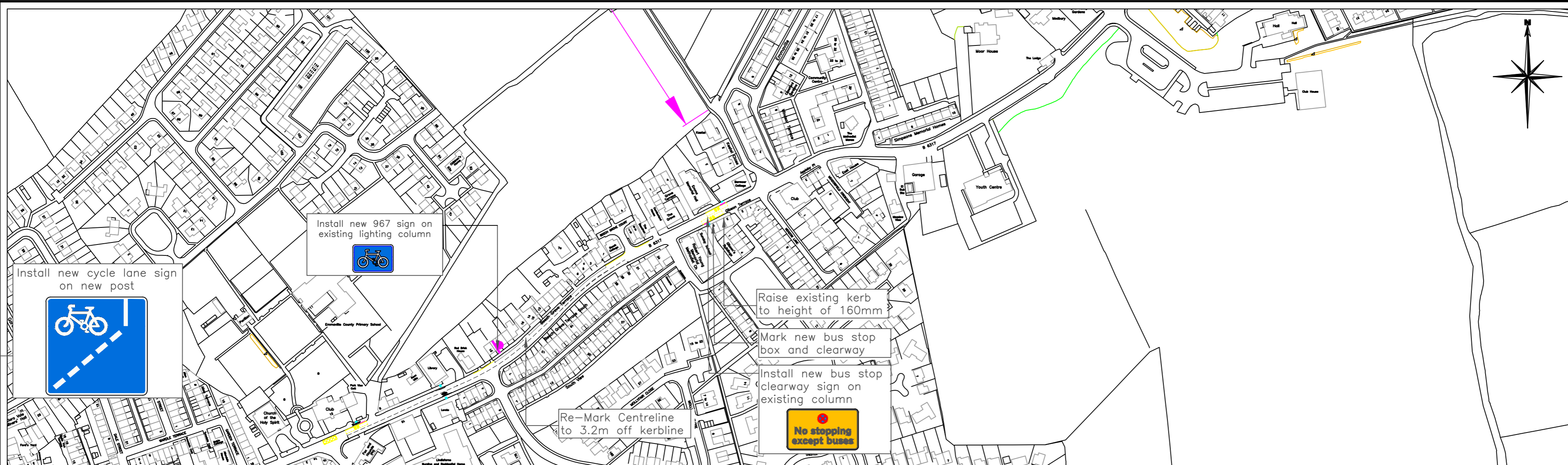
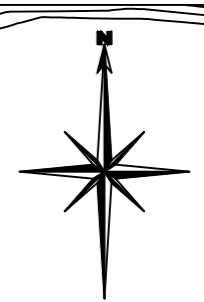

This map is reproduced from Ordnance Survey material with the permission of Ordnance Survey on behalf of the Controller of Her Majesty's Stationery Office. Crown copyright. Unauthorised reproduction infringes Crown copyright and may lead to prosecution or civil proceedings. Gateshead Council (D.S. license No 100019132) 2008

Rev	Date	Amendments	Prepared	Checked	Approved

Civil Centre
Ryton Street
Gateshead, NE8 1RH
Tel: 0191 4333000
Fax: 0191 4773555
www.gateshead.gov.uk

Development and Enterprise
Nicolas Clemett B.Sc., D.M.S., M.B.A., C.M.I.L.T., M.C.I.H.T.
Head of Transport Strategy

CLIENT:-

SCHEME NAME:-
Ryton to Northumberland

DRAWING TITLE:-
Cycle Link
Sheet 4 of 6
Crawcrook Centre

PREPARED BY:- J Thompson	DATE:- 10-05-2011
CHECKED BY:- N Frier	SCALE:- 1:2500
APPROVED BY:- I Gibson	DRAWING NO:- E/032/2/232
REV:-	A2