

IMPORTANT: THIS COMMUNICATION AFFECTS YOUR PROPERTY

TOWN AND COUNTRY PLANNING ACT 1990 (as amended by the Planning and Compensation Act 1991)

To: John Moody Jnr
Barn House
East Farm Court
Streetgate
Sunniside
Newcastle upon Tyne
NE16 5HD

BREACH OF CONDITION NOTICE

Issued by Gateshead Council

1. This is a formal notice which is issued by the Council under Section 187A of the above Act, because they consider that a condition or conditions imposed on a grant of planning permission relating to the land described below has not been complied with. They consider that you should be required to comply or secure compliance with the conditions specified in this notice.

2. The land affected by this notice.

The land at Whickham Industrial Estate, Swalwell shown edged in red on the attached plan.

3. The relevant planning permission.

The relevant planning permission to which this notice relates is the permission granted by the Planning Inspectorate on 19 November 2001 for the change of use from a builder's yard to use for the sale, fitting and storage of tyres.

4. The breach of condition.

The following conditions have not been complied with.

Condition 2

Within 8 months of the date this letter no tyres or other materials shall be stored in the open (that is outside the existing building or any other building or container subsequently approved in writing by the Council) on any part of the site.

Reference to 'this letter' in the above condition refers to the Decision Notice issued by the Planning Inspectorate 19 November 2001.

A copy of the letter is attached in Annex 1 to this notice.

5. What you are required to do.

You are required to comply or secure compliance with the stated condition by taking the following steps.

In order to comply with Condition 2 you should remove all tyres and other materials that are stored in the open on any part of the land outlined in red on the plan attached to this notice.

Supply copies of invoices and other written evidence showing lawful disposal of the tyres from the land to the Environment Agency.

Time for compliance 6 weeks beginning with the day this notice is served on you.

6. When this notice takes effect.

This notice takes effect immediately it is served on you or you receive it by postal delivery.

Dated 9 October 2002

Signed R. M. Kelly

Strategic Director Legal & Corporate Services

On behalf of Gateshead Council
Civic Centre, Regent Street
Gateshead
NE8 1HH

Warning:

There is no right of appeal against this notice

It is an offence to contravene the requirements stated in Paragraph 5 of this notice after the end of the compliance period. You will then be at risk of **immediate prosecution** in the Magistrates' Court, for which the maximum penalty is £1,000 for a first offence and for any subsequent offence. If you are in any doubt about what this notice requires you to do, you should get in touch immediately with the Officer named in the covering letter to this Notice in the Legal and Corporate Services at Gateshead Civic Centre (telephone 0191 4333000).

If you need independent advice about this notice, you are advised to contact urgently a solicitor, planning consultant or other professional adviser specialising in planning matters. If you wish to contest the validity of the notice, you may only do so by an application to the High Court for judicial review. A solicitor will advise you on what this procedure involves.

Do not leave your response to the last minute.

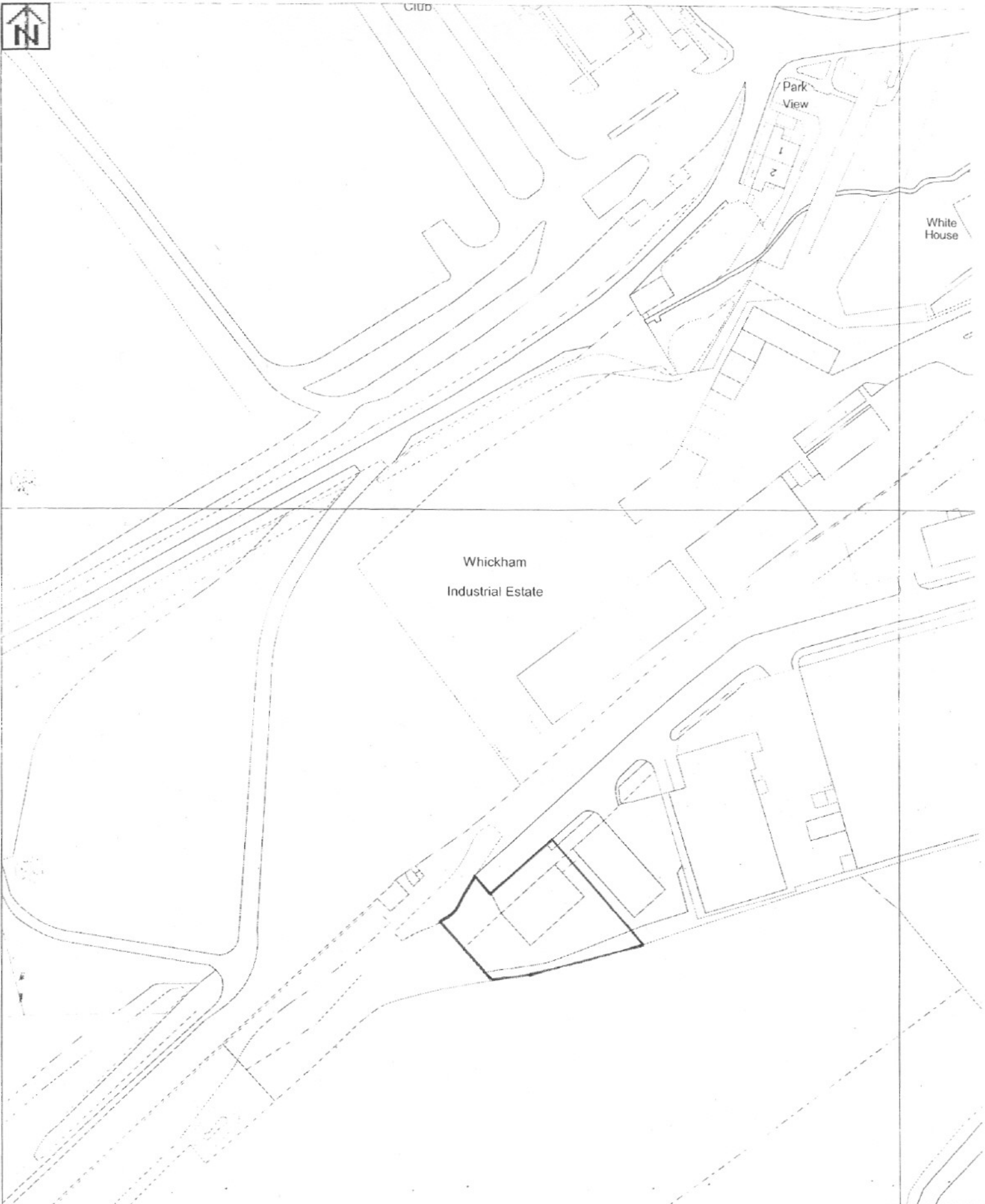

SWALWELL TYRES, WHICKHAM INDUSTRIAL ESTATE

This copy has been produced specifically for map return scheme purposes only. No further copies may be made. Reproduced from Ordnance Survey material with the permission of Ordnance Survey on behalf of the controller of HMSO (c) Crown copyright. Unauthorised reproduction infringes Crown copyright & may lead to prosecution or civil proceedings. GMBC LA07618X 1999

© Crown Copyright; Scale 1:1250